



# SETTING THE BASELINE

**FINAL PROGRAM**

**Maryland Assessment Group  
2017 Annual Conference**

**November 15-17, 2017  
Clarion Resort & Conference Center  
Ocean City, Maryland**

Join us on [Twitter](#) - [@MDAssessmentGrp](#)  
Facebook - <https://www.facebook.com/mdassessmentgroup>

---

Join us on [Twitter](#) - [@MDAssessmentGrp](#)  
Facebook - <https://www.facebook.com/mdassessmentgroup>

**MARYLAND ASSESSMENT GROUP  
ANNUAL CONFERENCE**

**NOVEMBER 15-17, 2017  
CLARION RESORT & CONFERENCE CENTER  
OCEAN CITY, MARYLAND**

**MAG BOARD OF DIRECTORS**

Deborah Gilmartin  
Melissa Mulligan  
Heather Lageman

Julian Katz, Executive Director  
Deborah Gilmartin, Program Director  
Marcia Porter, Media Specialist

**The MAG Board of Directors wishes to thank the vendors and sponsors for their financial support. Their support and contributions reduce the cost of this conference for Maryland educators.**

*Conference arrangements provided by CONFERENCE SOLUTIONS*

Join us on [Twitter](#) - [@MDAssessmentGrp](#)  
Facebook - <https://www.facebook.com/mdassessmentgroup>

**PRE-CONFERENCE SESSIONS**  
**Wednesday, November 15, 2017 10:30 a.m. – 3:15 p.m.**  
Salon B, Admission Ticket Required

**10:30 a.m. – 12:00 p.m. SESSION 1**  
**12:00 p.m. – 12:45 p.m. LUNCH**

**1:00 p.m. – 2:30 p.m. SESSION 2**  
**2:30 p.m. – 3:15 p.m. Book Signing**

**SESSION 1**

**Michael Toth**

**“NEW PEDAGOGY FOR A NEW CENTURY”**

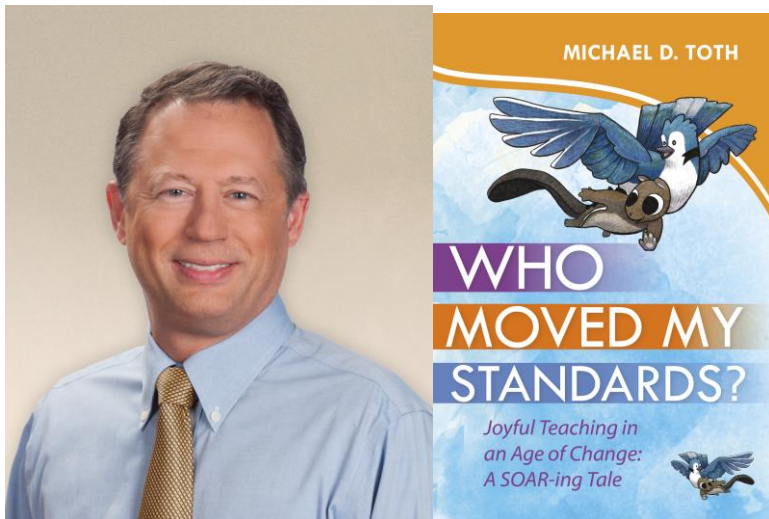

Artificial intelligence is developing so fast that 50% of existing jobs will be automated over the next ten years and our economy has evolved faster than our educational system. We need to create 'future-proof skills' for today's students. Join Michael Toth, respected researcher and author of *Who Moved My Standards*, *School Leadership for Results*, as well as other titles on instruction, as he explores how to transform classrooms from traditional to 21st century future-proof classrooms. Leave with an inspired vision for your school and district.

Here is the link to his book online where you can read a few chapters:

<https://www.learningsciences.com/who-moved-my-standards-joyful-teaching-in-an-age-of-change>



# Setting the Baseline

## WEDNESDAY, NOVEMBER 15, 2017

9:00 a.m. – 9:00 p.m.

### **REGISTRATION**

Lower Terrace Lobby

10:30 a.m. – 3:15 p.m.

### **PRE-CONFERENCE SESSIONS**

Salon B

Ticket Required for Admission – See description, opposing page

### **VENDOR DISPLAYS IN THE VENDOR EXHIBIT HALL:**

Starting on Wednesday, November 15, 2017 at 3:30 p.m. and closing on Thursday, November 16, 2017 at 5:30 p.m.

### **AUDIENCE FOCUS CODES:**

E=Elementary School

MA=Minority Achievement

G=General, Geared to All

M=Middle School

R=Research

H=High School

3:30 p.m. - 5:45 p.m., Salon B

### **Local Accountability Coordinators' Meeting**

**Led by Dr. Doug Strader, MSDE**

Local Accountability Coordinators and MSDE staff will gather for a formal state meeting.

3:30 p.m. - 4:30 p.m., Conference Room 1

Audience Code: G

### ***“Make and Take Madness!”***

**Presenters: Pamela Mesta, Melissa Thomas, & Mandy Chappell, Carroll County**

Are you looking for new ways to ignite your teaching? Don't spend a fortune buying things! Come to this highly interactive session to gain new, inexpensive ideas for active engagement with a special focus on diverse learners! Walk away with a folder full of authentic resources...created by you!

3:30 p.m. - 4:30 p.m., Conference Room 2

Audience Code: G

### ***“Meeting the Challenge of Personalized Learning: Implementing Personalization at Scale”***

**Presenter: Jordan Savitt, Renaissance Learning**

Join us to bring new understanding to personalized learning. You will gain clarity in defining personalization – what it is, and what it isn't. Discover insights to overcome personalization's research dilemma. Know which areas you'll want to explore with caution and learn practical ideas on implementing personalized learning at scale. District and school leaders will see how Renaissance products support the journey to personalized learning.

## WEDNESDAY, NOVEMBER 15, 2017

3:30 p.m. - 4:30 p.m., Conference Room 3

Audience Code: G

### ***“Targeting Standards with Item Types & Assessment Design”***

**Presenter: Dave Nelson, Performance Matters**

This session will focus on best practices in designing well-targeted items in both traditional and technology-enhanced formats in order to address the specific learning targets and informational needs of students, teachers and administrators. At both the classroom and district level, the session connects the blueprinting process, learning targets, standards and assessment design as each a fundamental element of a coherent planning and administration process.

3:30 p.m. – 4:30 p.m., Conference Rooms 4 & 5

Audience Code: G

### ***“Exploring New PearsonAccessNext and TestNav Updates”***

**Presenters: Jeff Heathman and Rebecca Hoeft, Pearson**

In this session, Pearson will review their 2017-2018 product release schedule. Learn about new feature updates and see demonstrations in PearsonAccessNext 4.2 & 4.3 and TestNav 8.9 & 8.10.

3:30 p.m. - 4:30 p.m., Conference Room 6

Audience Code: G

### ***“Accountability and Health Education”***

**Presenter: Kirsten Roller, MSDE**

Maryland's ESSA plan, the “Start Talking Maryland Act” of 2017, and “Erin’s Law” of 2016 have focused new attention on health education PreK-12. Learn about the legislative requirements related to opioid addiction and prevention education as well as sexual abuse and assault education. Session participants will learn how a skills-based approach facilitates active learning where students engage with the content in a relevant way to acquire the skills for lifetime health.

4:45 p.m. – 5:45 p.m., Conference Room 1

Audience Code: G

### ***“Understanding Item Analysis using the Data Management and Reporting System (DMRS)”***

**Presenters: Sarah Crisman & Jennifer Neidenbach, Prince George's County**

Get a hands-on look at the public release items from PARCC as they are displayed in the Item Analysis report in DMRS. We will take a closer look at how the standards and public release items relate to a student’s overall score.

4:45 p.m. – 5:45 p.m., Conference Room 2

Audience Code: G

### ***“Utilizing NWEA MAP Data to Impact Student Achievement and Teacher Practice”***

**Presenters: Georgia Clark & R. Joseph Buckley, Cecil County**

Cecil County Public Schools utilizes NWEA MAP testing for students in grades 2-8 in Reading and Mathematics. Presenters will share how they translated test performance data into instructional practice. Learn strategies used that resulted in the greatest percent growth in PARCC data in ELA and Math in the state and how individual schools, principals and teachers affected a change in teacher performance.

**WEDNESDAY, NOVEMBER 15, 2017**

4:45 p.m. – 5:45 p.m., Conference Room 3

Audience Code: G

***“Effective Mentoring Conversations”***

**Presenter: Daniel Capozzi, MSDE**

Facilitating conversations between coaches/mentors and new teachers: Entry points, questioning, and NTC's Collaborative Assessment Log.

4:45 p.m. – 5:45 p.m., Conference Rooms 4 & 5

Audience Code: G

***“Best Practices for PARCC”***

**Presenters: Diane Jenkins, Leigh Ann Anderson, and Ian Buter, Charles County & Patti West-Smith, Turnitin**

While PARCC is confined to specific courses, the thinking and practice required to master those skills is not. Because we know writing is one of those essential skills for PARCC, students must practice writing throughout their coursework. To do it well, they need to write often and receive ongoing, formative feedback. In this session, discuss how to leverage technology to support literacy, communication, consistent expectations, and feedback across all content areas.

4:45 p.m. – 5:45 p.m., Conference Room 6

Audience Code: G

***“Three Ways Leaders Can Create a Standards-Based Mindset”***

**Presenter: Lisa Lienemann, Learning Sciences International**

Whether you are a principal, instructional coach, or teacher leader, you play a role in shifting to a standards-based mindset. Hear about three concrete steps you can take to deepen teacher understanding of their standards, monitor the transition to a new mindset, and create assessment literate teachers.



**WEDNESDAY, NOVEMBER 15, 2017**

5:45 p.m. – 7:00 p.m. **DINNER BUFFET** - Crystal Ballroom

7:00 p.m. – 8:00 p.m., Crystal Ballroom

**OPENING KEYNOTE ADDRESS**

**Offered and Introduced by Beth Carr, Learning Sciences International**

***“Core Instruction for Formative Assessment”***

**Presenter: Michael Toth**

Michael Toth, author of *Who Moved My Standards* and CEO of Learning Sciences International and the LSI Center for Applied Research, explains how traditional core instruction is a barrier to effective minute-to-minute formative assessment and how teachers can overcome this barrier through student-centered strategies. Mr. Toth will also share a case study and promising research to support this approach.

***“Whatever Happened to Creativity in Our Schools?”***

**Presenter: David Sousa**

Neuroscience research supports the notion that we can actually teach students to be more creative. This keynote examines how programs like STEM may be inadvertently hindering student creativity, and what we can do about it. You will be stunned to discover what students say about creativity in our schools.

8:00 p.m. – 10:00 p.m., Salon B

***Cocktail Reception***

**Sponsored by Pearson**

**THURSDAY, NOVEMBER 16, 2017**

7:00 a.m. – 2:00 p.m.           **REGISTRATION** - Lower Terrace Lobby

7:15 a.m. – 8:30 a.m.           **BREAKFAST BUFFET** - Crystal Ballroom

8:30 a.m. – 9:30 a.m., Salon B

***“ESSA: Accountability in Maryland”***

Audience Code: G

**Presenter: Chandra Haislet, MSDE**

Attendees will learn about the development of Maryland’s accountability program as required under the Every Student Succeeds Act (ESSA). The components and the implementation of the Accountability System will be discussed. Attendees will learn how to use the information reported from Maryland’s Accountability Program to inform decision making.

8:30 a.m. – 9:30 a.m., Conference Room 1

Audience Code: G

***“Hidden in Plain View: Six Keys to Taking Success to Scale”***

**Presenter: Ronald Thomas, Towson University**

How can schools take the success of a few high-performing teams to scale across an entire school, or, parlay the success of a few schools across an entire district? This session will help you spot the keys to school-wide success and implement evidence-based improvement strategies to increase teacher and student learning across your whole school.

8:30 a.m. – 9:30 a.m., Conference Room 2

Audience Code: M

2 hour presentation, Part 1 of 2

***“Re-envision your Curriculum System: ELA Focus”***

**Presenter: Carla Moore, Learning Sciences International**

What are the attributes of a literacy classroom that meet the demands of ELA shifts for CCR Standards? Adapting instruction to meet the shifts for ELA can seem daunting. In this session, we will share strategies to help ensure your lesson plans and instructional techniques meet the levels of rigor required for student success. Discover powerful tools to create a thriving literacy culture where every student can become a successful reader and writer.

8:30 a.m. – 9:30 a.m., Conference Room 3

Audience Code: G

***“Implementing Formative Assessments in a K-8 Special Ed Setting”***

**Presenters: Despina Moniodis, Shelly Ritchie, & Meredith Wyatt, Kennedy Krieger**

Learn about our yearlong process of developing, implementing, modifying, & analyzing formative assessments on a school and classroom level in the area of math. Presenters will discuss challenges and successes with creating an appropriate and attainable assessment through collaboration, data collection and modifications.

## **THURSDAY, NOVEMBER 16, 2017**

8:30 a.m. – 9:30 a.m., Conference Rooms 4 & 5

Audience Code: G

### ***“Got Data? Now Make It Work For You!”***

**Presenters: Jaime Bowers, MSDE & Kathy Johnson, Pearson**

Education's favorite four letter word, DATA, can be a powerful tool in understanding student performance and improving teaching and learning. Learn how to help inspire staff to identify the right assessment data points to make growth happen. The session will also discuss the importance of data discussions, collaborative data talks, and data planning meetings and the crucial role they play on the path to making positive change happen in a classroom, school, and district.

8:30 a.m. – 9:30 a.m., Conference Room 6

Audience Code: M

### ***“Using the Latest PARCC Mathematics Assessment Data to Inform Instruction”***

**Presenter: Nina Riggs, MSDE**

Analyze the released PARCC data from 2015-2017 for Grades 6-8, including Grade 8 Algebra 1. Discover trends across the evidence statements to target areas of weaknesses and strengths. Identify content trajectories within these areas, and explore ways to improve 2018 PARCC performance.

9:45 a.m. – 10:45 a.m., Salon B

Audience Code: G

### ***“Science Assessment Lessons Learned”***

**Presenters: Mary Thurlow & Ann Herrmann, MSDE**

This session will focus on building an understanding of the process of developing, implementing, & analyzing a statewide large-scale summative assessment for science based on the Next Generation Science Standards (NGSS). Presenters will discuss the challenges and successes of developing an integrated large-scale science assessment.

9:45 a.m. – 10:45 a.m., Conference Room 1

Audience Code: G

### ***“Making the Move to an SAT School Day”***

**Presenters: Deborah Gilmartin and Andrew Raith, Frederick County & Cindy Kelly, College Board**

Find out why Frederick County decided to implement an SAT School Day in lieu of administering PARCC 11<sup>th</sup> grade measures. The changes to the SAT test was the catalyst to creating a system that helps all students exceed. Content alignment, student support through Khan Academy, and educator support through the online portal all add to student success.

9:30 a.m. – 10:30 a.m., Conference Room 2

Audience Code: M

2 hour presentation, Part 2 of 2

### ***“Re-envision your Curriculum System: ELA Focus”***

**Presenter: Carla Moore, Learning Sciences International**

## **THURSDAY, NOVEMBER 16, 2017**

9:45 a.m. – 10:45 a.m., Conference Room 3

Audience Code: G

### ***“Learning from the Data: Avoiding the Pitfalls of the Most Common Errors on CCR Mastery Measures”***

**Presenters: Sonya Coleman and Ken Tam, Curriculum Associates**

What if you could plan instruction now to help your students successfully navigate the most common errors and misconceptions in Math and Reading on CCR assessments? Examining data from more than a million students who completed Mastery Measures in Math and Reading, this session will look at nationwide trends and offer suggestions for instructional strategies and tools to help educators address these frequent misconceptions and common errors.

9:45 a.m. – 10:45 a.m., Conference Rooms 4 & 5

Audience Code: G

### ***“Opportunities and Challenges for Educational Agencies in the Era of ESSA”***

**Presenters: Dr. Bonnie Hain, CenterPoint Education Solutions; Jennifer Young, Calvert County; & Denise Shorts, Worcester County**

Three leaders from vastly different educational agencies will discuss the opportunities and challenges in working to align local assessments with standards and large-scale assessment programs under ESSA. Speakers will share lessons learned on tools that support local assessment selection and development, and ways to communicate decisions effectively.

9:45 a.m. – 10:45 a.m., Conference Room 6

Audience Code: G

### ***“Utilizing NWEA MAP-Reading to Improve Instruction in a Large School District”***

**Presenters: Andrew Pruski & Christopher Gardy, Prince George's County**

The presentation will focus on Prince George's County Public Schools' transition from the Scholastic Reading Inventory to the NWEA MAP-Reading assessment. NWEA MAP-R data provides in-depth analysis for measuring Lexile bands and RIT scores to measure student progress in reading. Best practices for the NWEA MAP- Reading Assessment will also be covered.

11:00 a.m. – 12:00 p.m., Salon B

Audience Code: M

### ***“Strategies to Improve Algebra Knowledge in the Middle School Student”***

**Presenter: Nina Riggs, MSDE**

Analysis of released PARCC data from 2015-2017 for Grades 6-8 shows distinct areas of weakness surrounding algebraic thinking. In this session, participants will explore the evidenced based recommendations made by the What Works Clearinghouse and reflect on how these recommendations can be used to improve algebra knowledge in middle school students.

11:00 a.m. – 12:00 p.m., Conference Room 1 is VACANT

11:00 a.m. – 12:00 p.m., Conference Room 2

Audience Code: E

### ***“Student-Centered Goal Setting in the Gifted Classroom”***

**Presenters: David Warrenfeltz & Erica Hartley, Washington County**

Most classrooms have students on a wide variety of levels on any content's learning continuum. Formative assessment and data can be used to guide student-centered goal setting allowing teachers to personalize learning. Come learn about processes and resources to create a goal setting and goal achieving culture within your classroom!

**THURSDAY, NOVEMBER 16, 2017**

11:00 a.m. – 12:00 p.m., Conference Room 3

Audience Code: H

***“Graduation Validation: Ensuring Accurate Data Capture”***

**Presenter: Ben Goldberg, Baltimore City**

Baltimore City Public Schools will explain the graduation validation process which was designed to ensure that all graduates have met requirements. Discuss Baltimore City’s collaborative process that involves multiple departments and direct interface with schools. The presenter will seek feedback as they work consistently to improve the process.

11:00 a.m. – 12:00 p.m., Conference Rooms 4 & 5

Audience Code: G

***“UDL, Thinking Routines, and Formative Assessment”***

**Presenters: Steven Van Rees & Jackie Jacobs, Calvert County**

In this session, examine how thinking routines and protocols can assist in the development and demonstration of student understanding. Participants will have the opportunity to explore and experiment with several routines, each of which can be used in any content area.

11:00 a.m. – 12:00 p.m., Conference Room 6

Audience Code: G

***“Linking Thinking and Learning”***

**Presenters: Pamela Mesta & Brian Wienholt, Carroll County**

Come to this interactive session to explore "Universal Thinking Verbs," which are a common group of cross-curricular verbs that identify fundamental thinking skills necessary for success. Tons of instructional strategies and connections to learning objectives will be explored!

12:00 p.m. – 1:00 p.m.

**LUNCH BUFFET, Crystal Ballroom**

1:00 p.m. – 1:50 p.m. Crystal Ballroom

***ESSA Requirements and College Board’s Position in Other States***

**Presenter: David Adams, Vice President of Middle States and New England Regions  
&**

**Cindy Kelly, SAT/PSAT Regional Director, College Board**

How is the SAT playing into states’ ESSA plans? College Board’s accommodations will be discussed as well as the SAT Suite of Assessments and the partnership with Khan Academy. Learn how and why the system works to improve student performance.

2:00 p.m. – 2:45 p.m., Exhibit Hall, Salon A

**Dessert and Beverages**

**Vendor Discussions and Door Prizes**

*Must Be Present to Win!!!!*

## **THURSDAY, NOVEMBER 16, 2017**

2:45 p.m. – 3:45 p.m., Salon B

Audience Code: M/H

***“Noticing and Wondering” - A Closer Look at Spring 2017 PARCC Algebra I Data***

**Presenter: Debra Ward, MSDE**

What conclusions can be drawn from an in-depth analysis of the PARCC Algebra I data? This session will explore what the various PARCC Algebra I data reports do and do not reveal. Participants will gain a better understanding of the structure of the PARCC Algebra I assessment and the connections to how the data is reported.

2:45 p.m. – 3:45 p.m., Conference Room 1

Audience Code: G

***“Tech Toolbox”***

**Presenter: Marcia Porter, Caroline County**

Whether you are in a one-device room or a 1-to-1 setting, harness the power of technology to transform learning in your classroom. From planning to formative assessment to modifications for students on a plan, walk away with a variety of tech tools to be used with and by your students.

2:45 p.m. – 3:45 p.m., Conference Room 2

Audience Code: G

2 hour presentation, Part 1 of 2

***“Re-envision your Curriculum System: Math Focus”***

**Presenter: Carla Moore, Learning Sciences International**

What are the attributes of a mathematics classroom that meets the demands of shifts for CCR Standards? Adapting instruction to meet the shifts for math standards can seem daunting. In this session, we will share strategies to help ensure your lesson plans and instructional techniques meet the levels of rigor required for student success. We will help you make connections between math instructional shifts and Core Actions, and share tools that will help you develop a numeracy culture where every student can think like a mathematician.

2:45 p.m. – 3:45 p.m., Conference Room 3

Audience Code: G

***“Assessing to Inform Teaching and Learning: Formative Assessment Techniques for Every Classroom”***

**Presenters: Francis (Skip) Fennell, McDaniel College; Jon Wray, Howard County; & Beth Kobett, Stevenson University**

Assessment of student learning is the responsibility of every school/district and every teacher. Join us as we explore examples of the Formative 5 – classroom-based formative assessment techniques that are used to guide mathematics planning and teaching as well as monitor and assess learning in every classroom, every day!

## **THURSDAY, NOVEMBER 16, 2017**

2:45 p.m. – 3:45 p.m., Conference Rooms 4 & 5

Audience Code: R

### ***“Data Collections, Reporting, and More!”***

**Presenters: Matt Dammann & Laia Tiderman, MSDE**

Staff within the Office of Accountability will share updates on the status of current and upcoming data collections, changes in reporting, and anything else you would like to discuss! This session is intended for central office staff to understand the direction coming from MSDE in regards to data collection and reporting. Attendees will have an opportunity for interactive discussion and questions.

2:45 p.m. – 3:45 p.m., Conference Room 6

Audience Code: G

### ***“MSDE Reporting for MSAA and Alt-MISA: Using and Interpreting Assessment Results and Performance Level Descriptors”***

**Presenter: Marsie Torchon, MSDE**

This session will focus on reporting for ELA, Mathematics and Science for students who take the Alternate Assessments. We will discuss available data for each assessment and learn how to tie the performance level descriptors to instruction.

4:00 p.m. – 5:00 p.m., Conference Room: Salon B

Audience Code: G

### ***“Teacher to Teacher Learning: Cultivating Peer Coaching”***

**Presenters: Angela de Guzman & Laura Liccione, MSDE**

Learn about the peer coaching process as a tool for embedded professional learning. Participants will dive into the process, data, and protocols for peer coaching and look at examples from other school from around the state.

4:00 p.m. – 5:00 p.m., Conference Room 1

Audience Code: G

### ***“Fostering a Growth Mindset: Getting Results & Goalsetting”***

**Presenter: Judith Wilson, Montgomery County**

Fostering a growth mindset can impact student achievement in many ways. When students combine aspects of a growth mindset with goal setting, they track their own scores on MAP assessments (NWEA’s Measures of Academic Progress) and aim higher. See the tools teachers can use and ways to support success.

3:45 p.m. – 4:45 p.m., Conference Room 2

Audience Code: G

2 hour presentation, Part 2 of 2

### ***“Re-envision your Curriculum System: Math Focus”***

**Presenter: Carla Moore, Learning Sciences International**

**THURSDAY, NOVEMBER 16, 2017**

4:00 p.m. – 5:00 p.m., Conference Room 3

Audience Code: G

***“Student Growth Through the Use of PARCC Evidence Statement Reports and Formative Assessments”***

**Presenters: Julie Morrison & Amanda Garner, Calvert County**

Calvert County teachers who use the PARCC Evidence statements, performance level descriptors, and on-going formative assessment to guide instructional choices saw greater student growth than their peers. Learn how to drill down from PARCC evidence statements to daily instructional choices as you move your students to rigorous standards.

4:00 p.m. – 5:00 p.m., Conference Rooms 4 & 5

Audience Code: G

***“Using Item-Level Analytics to Improve Assessment & Inform Curriculum”***

**Presenter: Dave Nelson, Performance Matters**

Using both classical test theory and modern measurement models contextualized to tests with given purposes, this workshop-style professional development will explore the ideal distribution of item difficulty, the importance of item discrimination (and its location) and the use of distractor analysis to revise items and gain information about student understanding and ability.

4:00 p.m. – 5:00 p.m., Conference Room 6

***“Secret Sauce of a School's Success: PLC's and Data Chats!”***

**Presenters: Laura Arenella and Liz Glover Worcester County & Ken Tam, Curriculum Associates**

Worcester County students achieve deeper understanding of standards as a result of conducting PLCs to analyze formative assessment data and planning for rigorous instruction. Regular data chats help educators use real-time assessment data to identify challenges and empower students to own their growth. Join representatives from Buckingham Elementary School as they share their experience and model effective data chat strategies.

5:30 p.m. – 7:00 p.m., Salon B

**Cocktail and Social Hour**

**In Appreciation of Conference Participants**

***Sponsored by the Clarion Resort & Conference Center***

6:30 p.m. – 8:00 p.m. **DINNER**, Crystal Ballroom

***Sponsored by Pearson***

8:00 p.m. – ?

**MAG NIGHT AT THE CLARION**

Horizon's Restaurant





**FRIDAY, NOVEMBER 17, 2017**

8:00 a.m. – 9:00 a.m., Conference Room 3

Audience Code: H

***“PSAT/NMSQT for Grade 10”***

**Presenter: Marilyn Powell, Montgomery County**

This study examines trends in redesigned PSAT/NMSQT participation and performance among Grade 10 test takers, providing information about students’ progress toward meeting college and career readiness benchmarks. Areas of strength and need are highlighted to assist instruction.

8:00 a.m. – 9:00 a.m., Conference Rooms 4 & 5

Audience Code: G

***“Selecting Evidence-Based Programs and Interventions”***

**Presenter: Dara Shaw, MSDE**

Federal law and good decision-making requires choosing educational programs based on evidence that links that program to the current problem. But finding, interpreting, and evaluating "evidence" is challenging. There is a lack of understandable sources and a flood of research that is difficult to apply. Learn how to define "evidence-based" activities, strategies, and interventions; locate evidence about those activities; and evaluate the evidence to determine if the activity or program is truly evidence-based.

8:00 a.m. – 9:00 a.m., Conference Room 6

Audience Code: G

***“Impacting Student Engagement through Professional Peer Coaching: A Model of Differentiation for Educators”***

**Presenters: Laura Breeding, Jaclyn Murray-Lockerman & Shawn Parks, Caroline County**

Classroom teachers will discuss Lockerman Middle School’s evolution into professional peer coaching and share their model of progression from pineapple walk observations to a traditional one on one peer coaching partnership. With the goal of increasing student engagement, this differentiated approach makes professional peer collaboration accessible to all staff.

9:15 a.m. – 10:15 a.m., Salon A

Audience Code: G

***“Breaking Down Assessment Barriers One Data Point at a Time”***

**Presenters: Jaime Bowers and Laura Liccione, MSDE & Kristie Schmidt, Frederick County**

We will be engaging in a discussion surrounding state assessment reporting data, collaborating on how to facilitate data discussions within your school or district, utilizing the data to enhance teaching and learning, and demonstrating how other data sources can be incorporated into the teaching and learning process to help make instructional decisions.

9:15 a.m. – 10:15 a.m., Salon B

Audience Code: MA

***“How to Help Students Using PARCC ELA Data”***

**Presenters: Kathleen Maher-Baker & Ava Spencer, MSDE**

ELA PARCC data will be reviewed in order to identify instructional needs and the needs of underrepresented groups.

## **FRIDAY, NOVEMBER 17, 2017**

9:15 a.m. – 10:15 a.m., Conference Room 1

Audience Code: E/M

### ***“Google “Plus” Web 2.0 - Assessment to Teach and Not Judge”***

**Presenter: Tiana Dempsey, Prince George's County**

Formative Assessment has never been more convenient or overwhelming! Learn some different strategies using Google Apps for Education and other Web 2.0 tools in order to formatively assess student thinking. Learn how students can get involved in the process to create and assess each other's work. Learn free resources to implement in classrooms tomorrow even if your school is not one-to-one with technology.

9:15 a.m. – 10:15 a.m., Conference Room 2

Audience Code: G

### ***“Student Assessment with iPad”***

**Presenter: Apple**

Online assessment is now an integral part of the classroom experience. Join us to see how iPad is a powerful device for supporting daily learning, all well as for formative assessments and administering annual state tests. Find out how Automatic Assessment Configuration makes it easy to secure iPad for summative assessments. You'll learn how iPad can securely and reliably support all types of assessments.

9:15 a.m. – 10:15 a.m., Conference Room 3

Audience Code: G

### ***“Personal Needs Profile Process: Ensuring accommodations Data is Accurate and Updated”***

**Presenter: Krishna Miller, Baltimore City**

Baltimore City Public School developed a Personal Needs Profile process to collect accommodations data needed to enable features in the PearsonAccess Next testing platform. The presentation will share the process and lessons learned.

9:15 a.m. – 10:15 a.m., Conference Rooms 4& 5

Audience Code: E

### ***“Using PARCC Release Tasks to Create Reasoning and Modeling Problems”***

**Presenter: Linda Schoenbrodt, MSDE**

PARCC data shows that students need support and additional practice with reasoning and modeling problems. During this session, participants will analyze PARCC release tasks to identify the structure of these problems so they will be able to create reasoning and modeling problems to use in their classrooms. PARCC scoring tips will also be shared for these types of problems.

9:15 a.m. – 10:15 a.m., Conference Room 6

Audience Code: G/H

### ***“Grade 9 Course Prediction Model”***

**Presenter: Helen Wang, Montgomery County**

The research built a Grade 9 course prediction model on Measures of Academic Progress and other academic and behavioral predictors through complex data compiling and analysis. The prediction information helps high schools plan instruction to keep students at risk of course failure stay on track toward college and career readiness.

**FRIDAY, NOVEMBER 17, 2017**

10:15 a.m. – 11:15 a.m.

**BRUNCH and ANNOUNCEMENTS**, Crystal Ballroom  
**Sponsored by**

11:15 a.m. – 12:30 p.m., Crystal Ballroom

**CLOSING KEYNOTE ADDRESS**

**Presenter: Carla Moore, Learning Sciences International**

***“Achieving a Standards-Driven Curriculum”***

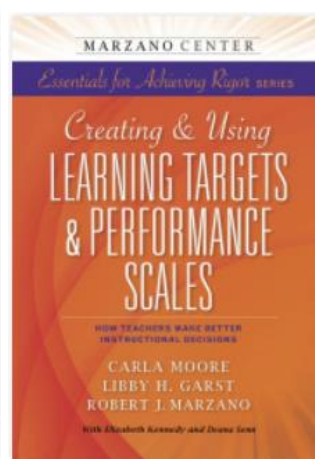
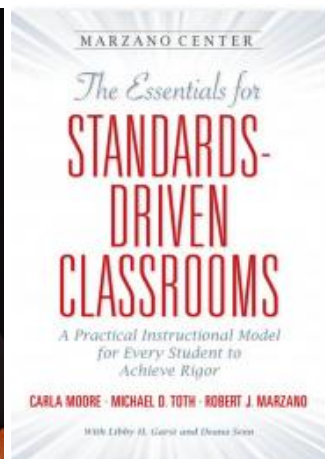

How do you accelerate the quality of core instruction in your district, and how do you become a true standards-driven system? Carla Moore, LSI's National Practice Leader for Curriculum, will discuss the changes and levers to strengthen your curriculum system and the through-line to student achievement. Carla's insights from the field have uncovered the practices we need to achieve a standards-driven curriculum.

Here is the link to her books online where you can read a few chapters:

<https://www.learningsciences.com/catalogsearch/result/?q=carla+moore>

**FAREWELL AND GRAND PRIZE DRAWING AFTER KEYNOTE ADDRESS**

*Must be present to win!*



***Make plans for next year's conference!***

***MAG November 14-16, 2018***

Join us on [Twitter](#) - [@MDAssessmentGrp](#)

Facebook - <https://www.facebook.com/mdassessmentgroup>

# MEETING & BANQUET FACILITIES

## First Floor

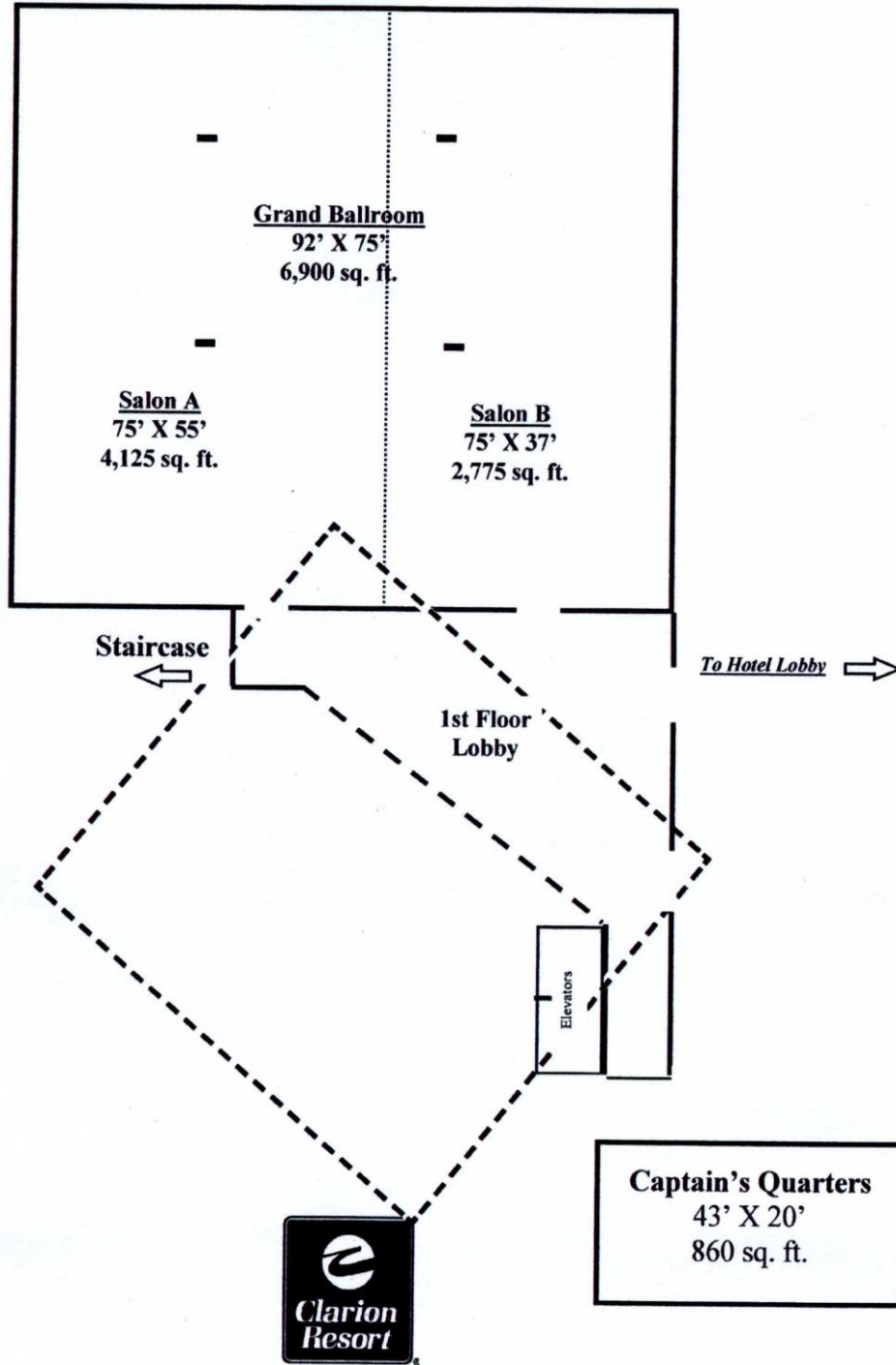

# MEETING & BANQUET FACILITIES

## Second Floor

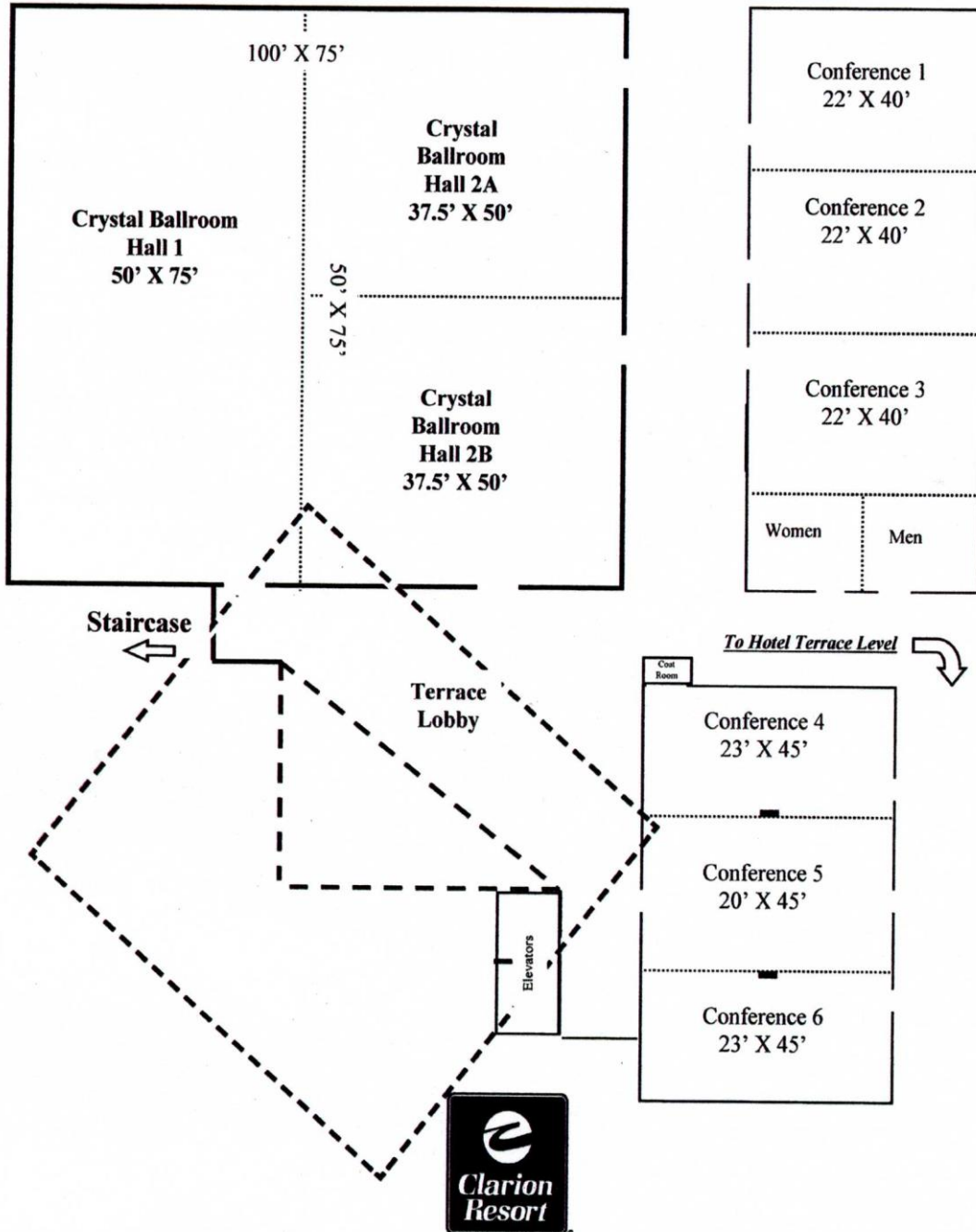

## Participating Vendors and Sponsors

*Please visit our vendors and sponsors throughout the conference in the Vendor Exhibit Hall  
Salon A*

<b>ORGANIZATION</b>	<b>REPRESENTATIVE</b>	<b>SPONSOR LEVEL</b>
Cengage Learning/National Geographic Learning	Donna Livingstone	Bronze
CenterPoint Education Solutions	Emily Alvarez	Bronze
College Board	Cindy Kelly	Gold
Curriculum Associates	Sonya Coleman	Gold
High Road Schools/Catapult Learning	Howard Axelrod	Bronze
Houghton Mifflin Harcourt	Dustin Tooley	Bronze
Learning Sciences International	Beth Carr	Gold
McGraw Hill Education	Heather Mooney	Bronze
Measured Progress	Barbara Bell	Bronze
NWEA	Steve Westfall	Silver
Pearson	Joy Heitland & Lisa Lopic	Platinum
Perfection Learning	Maureen Rich	Bronze
Performance Matters	Marnie Stockman	Gold
Perma-Bound Books	Joe Lenza	Bronze
Renaissance Learning, Inc.	Jordan Savitt	Silver
Taylor Book Group	Lauri Taylor	Bronze
TC Education- Heinemann	Cam McIntyre	Bronze
Turnitin	Melissa Perlman	Silver